

CANYON

DESIGNED FOR ADVENTURE

GIVI®



GRT709B
COUPLE OF SIDE BAGS

GRT709B

COPPIA DI BORSE LATERALI - COUPLE OF SIDE BAGS - PAIRE DE SACOCHES LATÉRALES
PAR DE BOLSAS LATERALES - PAAR SEITENTASCHEN- PAR DE BOLSAS LATERAIS

CLICCA QUI PER VISUALIZZARE LE ISTRUZIONI

Click **HERE** to view the instructions

Cliquez **ICI** pour voir les instructions

Haz clic **AQUÍ** para ver las instrucciones

Klicke **HIER**, um die Anweisungen anzusehen

Clique **AQUI** para ver as instruções



LINK:

<https://www.givi.it/qr/0016>

SCANSIONA PER VISUALIZZARE LE ISTRUZIONI

Scan to view the instructions

Scannez pour voir les instructions

Escanea para ver las instrucciones

Scanne um die Anweisungen anzusehen

Escaneie para ver as instruções

GRT709B

BORSE LATERALI 35+35LT - SIDE BAGS 35+35LTRS - SACOCHES LATÉRALES 35+35 LITRES SEITENTASCHEN MIT 35 + 35 LITER ALFORJAS LATERALES 35+35 LITROS - SACOS LATERAIS 35 + 35 LITRO

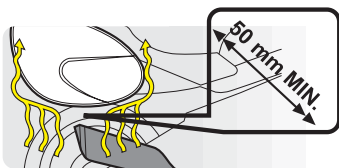
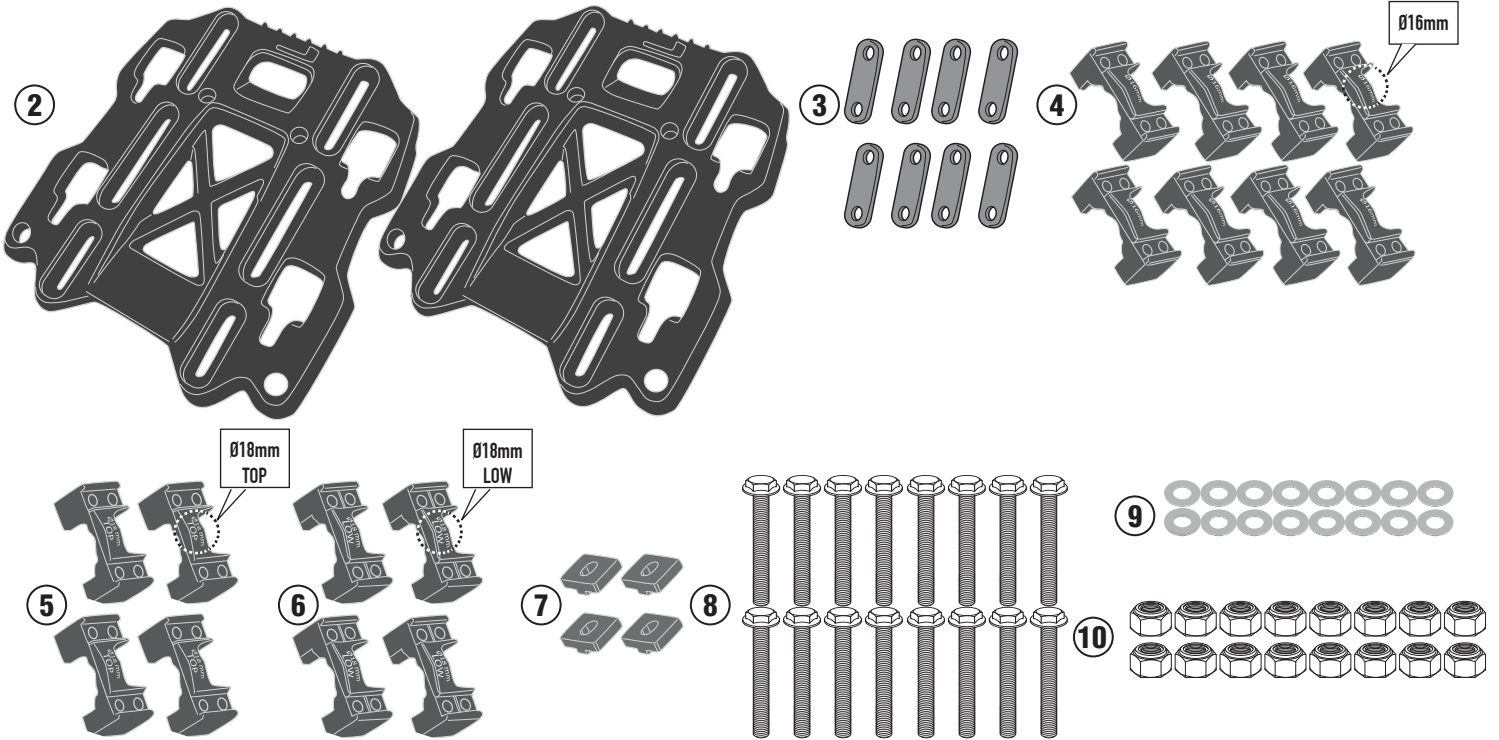

ATTENZIONE: Tenere le borse a una ragionevole distanza dalla marmitta. Il calore e i fumi di scarico potrebbero danneggiarle.

WARNING: Keep the bags a reasonable distance from the silencer. The heat and the exhaust could damage them.

ATTENTION: Tenez les sacoches à une distance raisonnable du système d'échappement. La chaleur et les gaz d'échappement pourraient les endommager.

ACHTUNG: Die Taschen in ausreichendem Abstand vom Auspuff andringen, um deren Beschädigung durch Hitze und Abgase zu vermeiden.

ATENCIÓN: Mantener las bolsas a una distancia razonable del tubo de escape. El calor y los humos de escape podrían dañarlas.

GRT709B

BORSE LATERALI 35+35LT - SIDE BAGS 35+35LTRS - SACOCHES LATÉRALES 35+35 LITRES SEITENTASCHEN MIT 35 + 35 LITER
ALFORJAS LATERALES 35+35 LITROS - SACOS LATERAIS 35 + 35 LITRO

MOUNTING ON PL...CAM

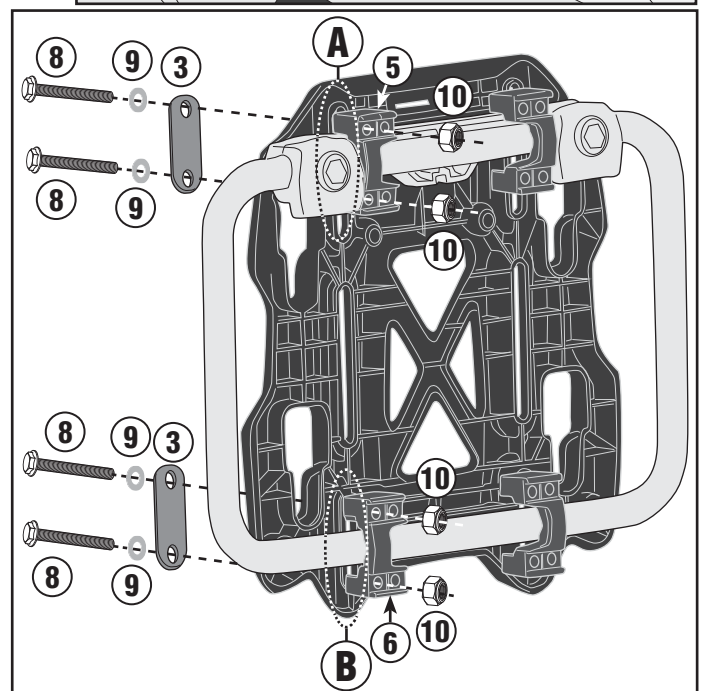
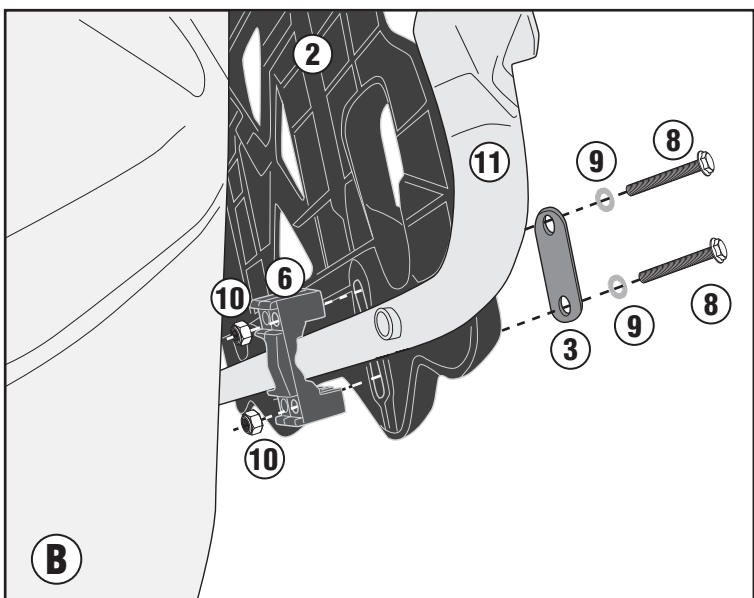
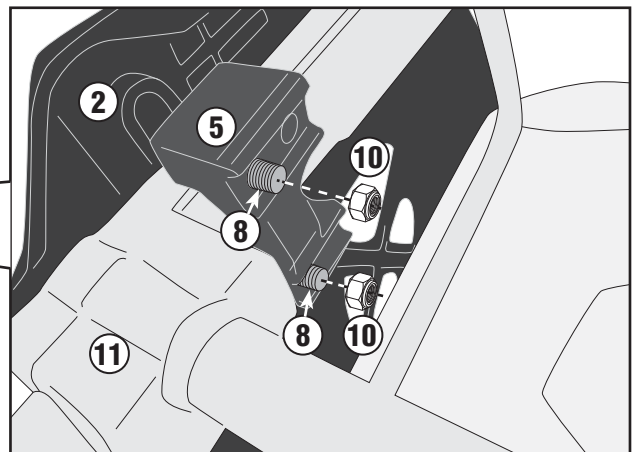
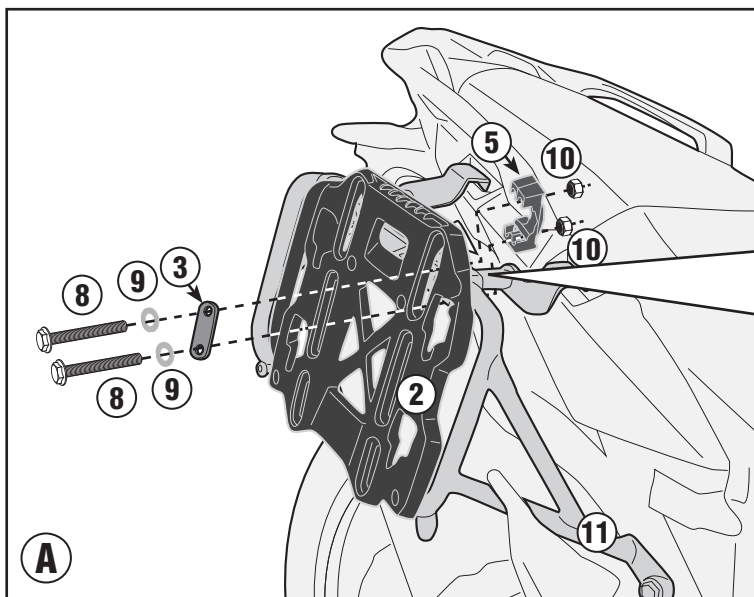
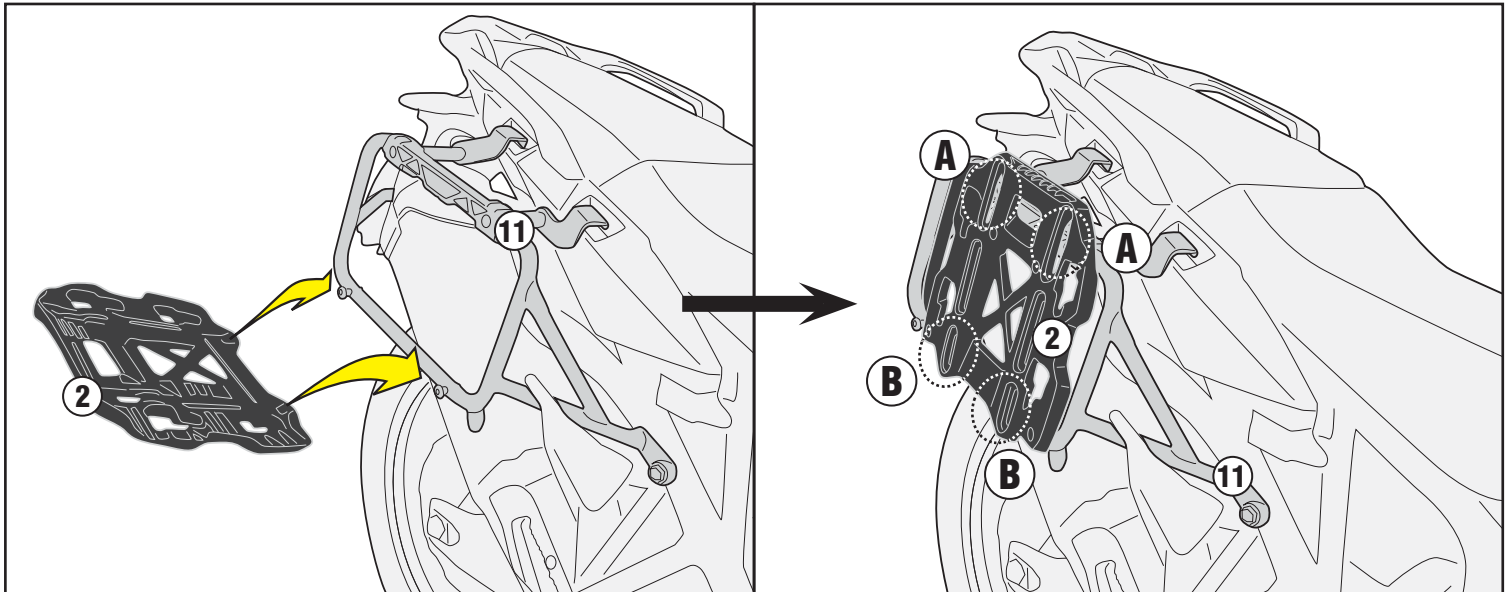

ISTRUZIONI DI MONTAGGIO - MOUNTING INSTRUCTIONS
INSTRUCTIONS DE MONTAGE - BAUANLEITUNG
INSTRUCCIONES DE MONTAJE - INSTRUÇÕES DE MONTAGEM

GRT709B

BORSE LATERALI 35+35LT - SIDE BAGS 35+35LTRS - SACOCHES LATÉRALES 35+35 LITRES SEITENTASCHEN MIT 35 + 35 LITER
ALFORJAS LATERALES 35+35 LITROS - SACOS LATERAIS 35 + 35 LITRO

MOUNTING ON PL/PLR

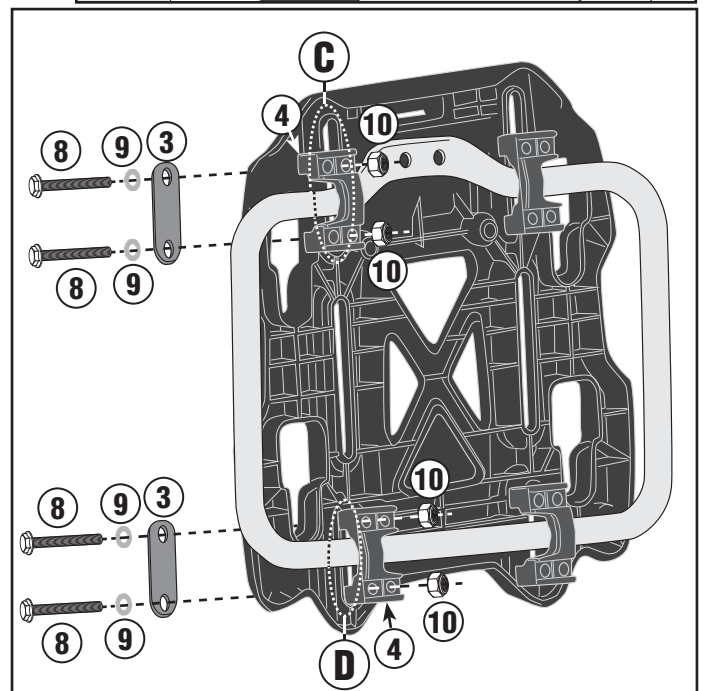
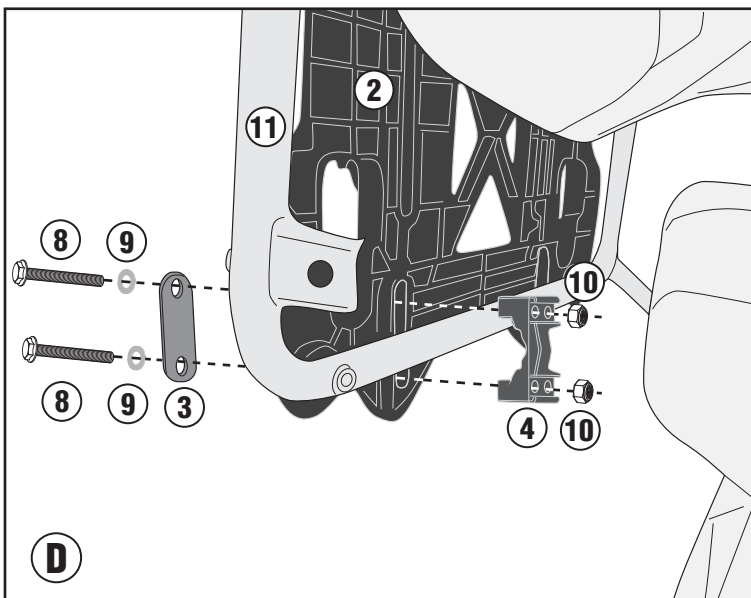
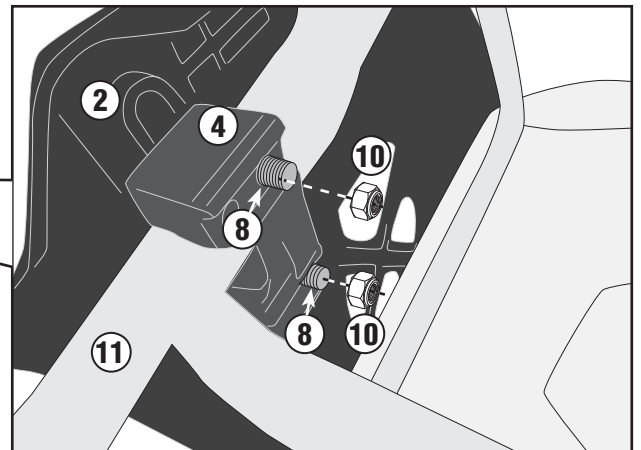
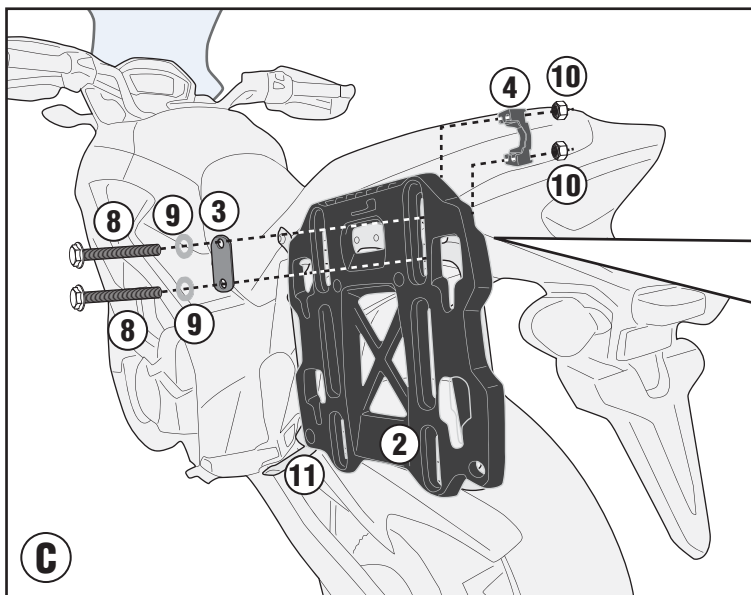
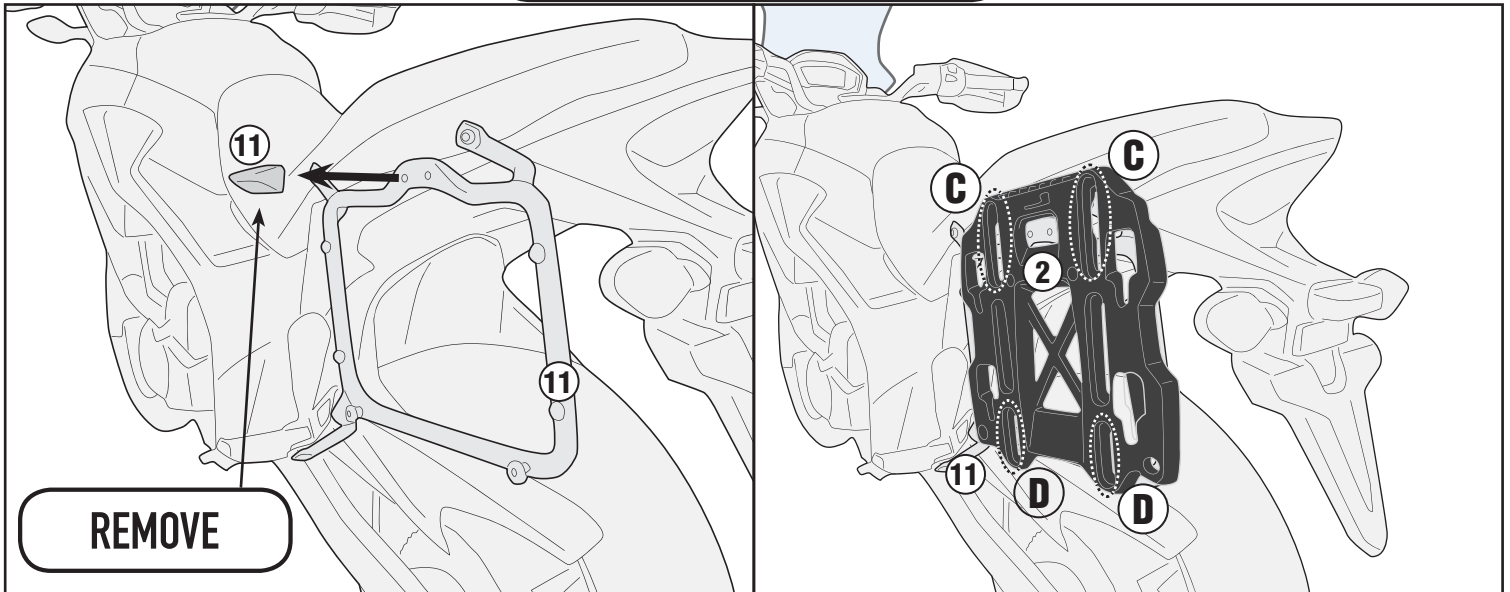

ISTRUZIONI DI MONTAGGIO - MOUNTING INSTRUCTIONS
INSTRUCTIONS DE MONTAGE - BAUANLEITUNG
INSTRUCCIONES DE MONTAJE - INSTRUÇÕES DE MONTAGEM

GRT709B

BORSE LATERALI 35+35LT - SIDE BAGS 35+35LTRS - SACOCHES LATÉRALES 35+35 LITRES SEITENTASCHEN MIT 35 + 35 LITER
ALFORJAS LATERALES 35+35 LITROS - SACOS LATERAIS 35 + 35 LITRO

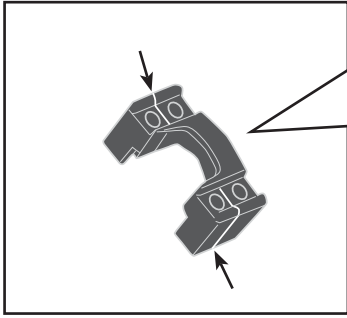

- Nel caso in cui il cavallotto faccia interferenza con altri componenti, è possibile togliere la parte eccedente premarcata con l'aiuto di un seghetto.
- Should the retaining clamp be incompatible with other components, remove the (pre-marked) excess with a hacksaw.
- Si le cavalier touche d'autres composants, il est possible de couper la partie excédentaire pré-marquée à l'aide d'une scie à métaux.
- En caso de que la puente cree interferencia con otros componentes, se podrá eliminar la parte que excede premarcada con una sierra.
- Sollte die Bügelklemme mit anderen Komponenten nicht kompatibel sein, schneiden Sie den überschüssigen Teil (vormarkiert) mit einer Säge ab.
- Caso a abraçadeira de fixação crie interferência com outros componentes, será necessário cortar a parte excedente pré-marcada com uma serra.

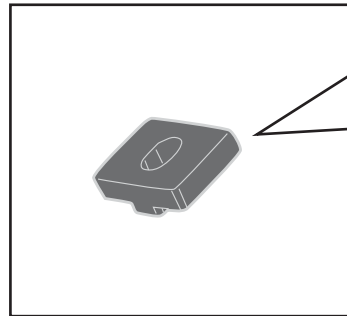

- Adattatore da utilizzare nel caso in cui si montino le GRT709 su telai non Givi e ci sia la necessità di azzerare dei giochi tra gli elementi.
- Adapter to be used if the GRT709 is mounted on non-Givi frames and there is a need to eliminate any sagging between the elements.
- Adaptateur à utiliser - si nécessaire- en cas de montage des GRT709 sur châssis non Givi, pour éliminer les jeux entre les éléments.
- Adaptador a utilizar cuando se coloquen las GRT709 en soportes que no sean GIVI y sea necesario anular el juego entre los elementos.
- Adapter zur Montage der GRT709 auf einen Nicht-GIVI-Träger, damit ein Spielraum zwischen den Elementen vermieden wird.
- Adaptador para ser utilizado quando a bolsa GRT 709 for montada em suportes que não sejam da marca GIVI e seja necessário ajustar a folga entre os elementos.

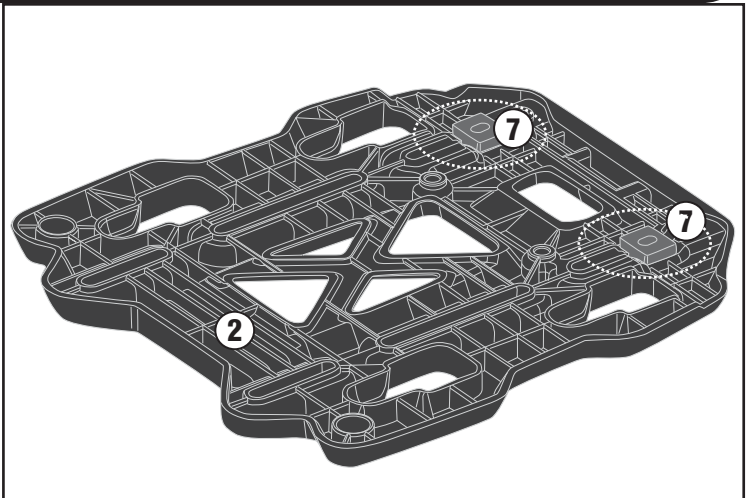
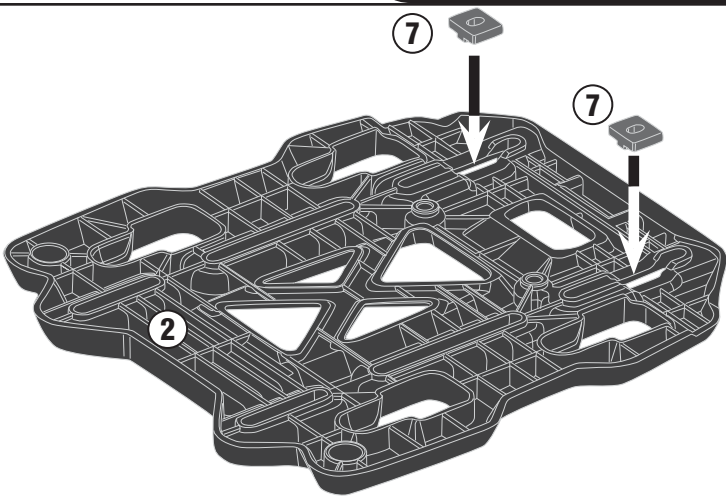

OTHER FRAME (NOT GIVI)

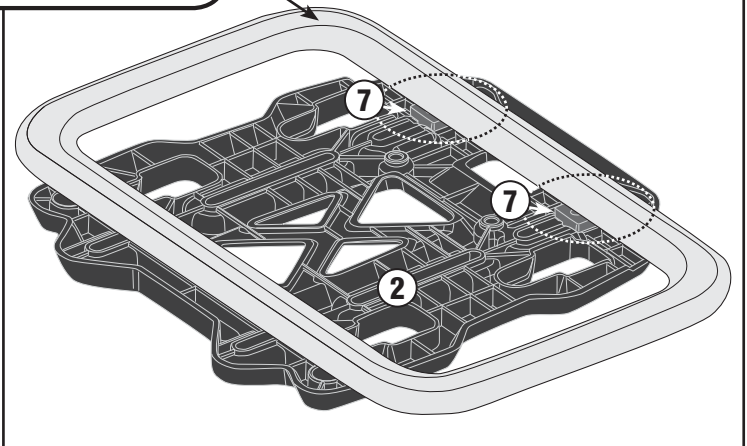
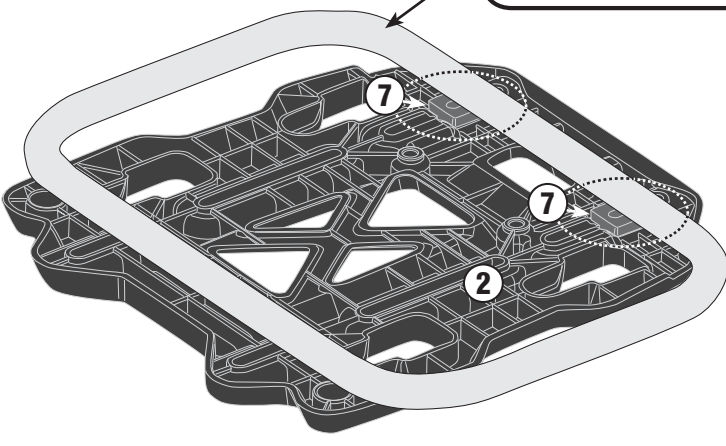

GRT709B

BORSE LATERALI 35+35LT - SIDE BAGS 35+35LTRS - SACOCHES LATÉRALES 35+35 LITRES SEITENTASCHEN MIT 35 + 35 LITER
ALFORJAS LATERALES 35+35 LITROS - SACOS LATERAIS 35 + 35 LITRO

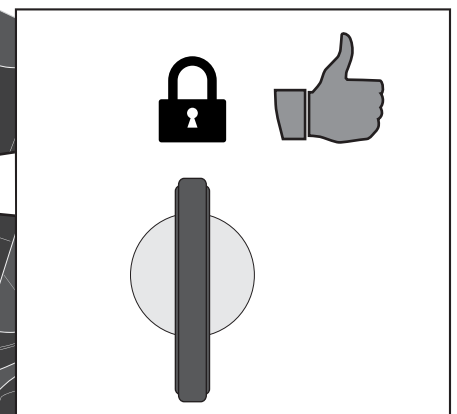
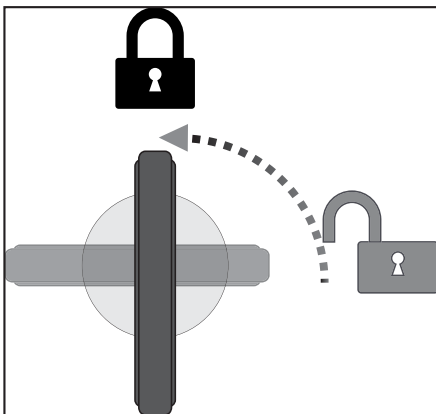
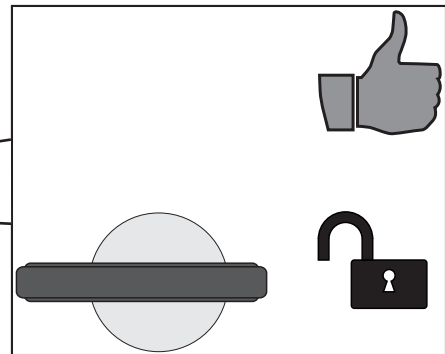
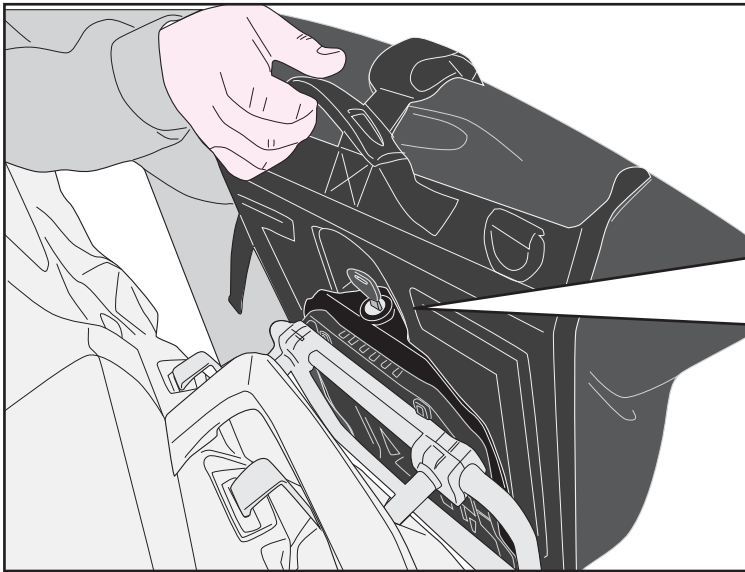
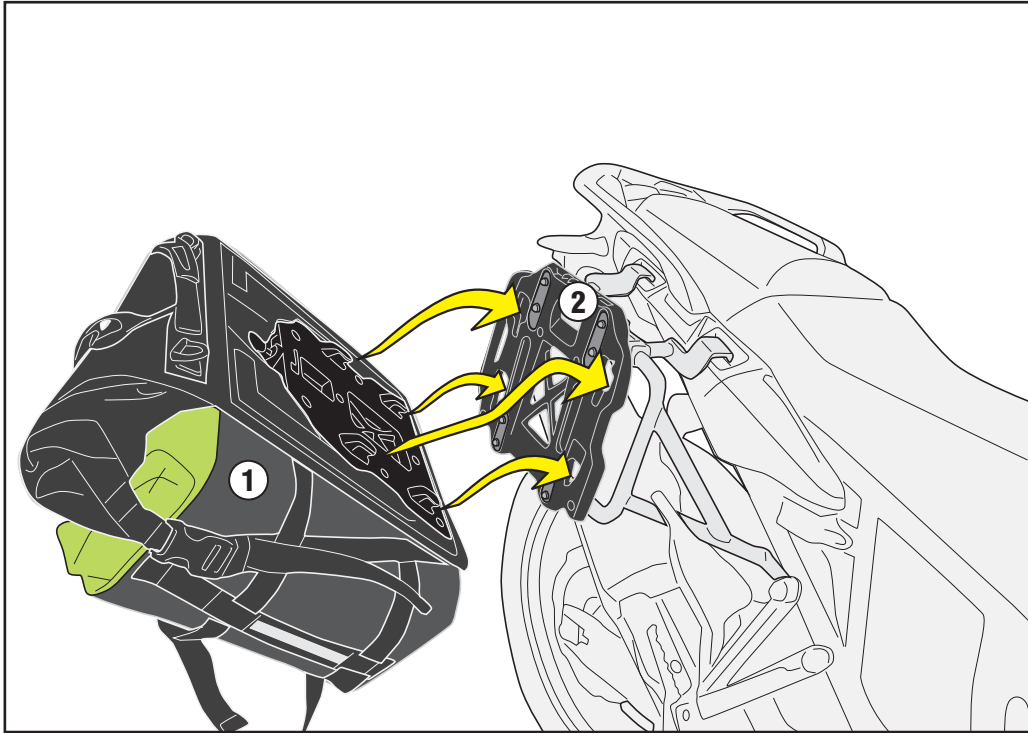

GRT709B

BORSE LATERALI 35+35LT - SIDE BAGS 35+35LTRS - SACOCHES LATÉRALES 35+35 LITRES SEITENTASCHEN MIT 35 + 35 LITER
ALFORJAS LATERALES 35+35 LITROS - SACOS LATERAIS 35 + 35 LITRO

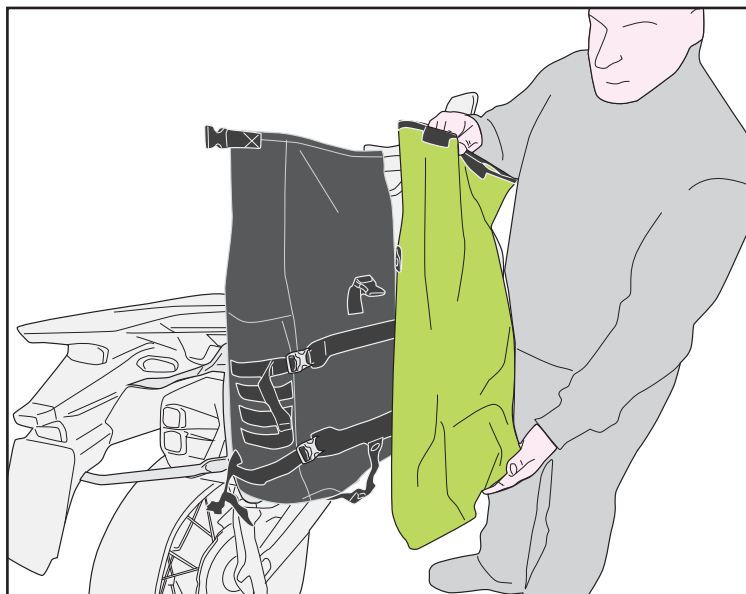
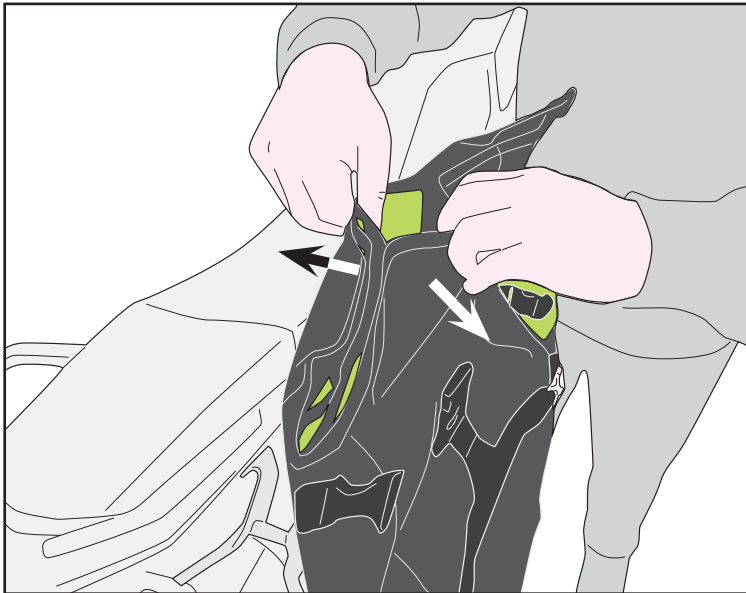
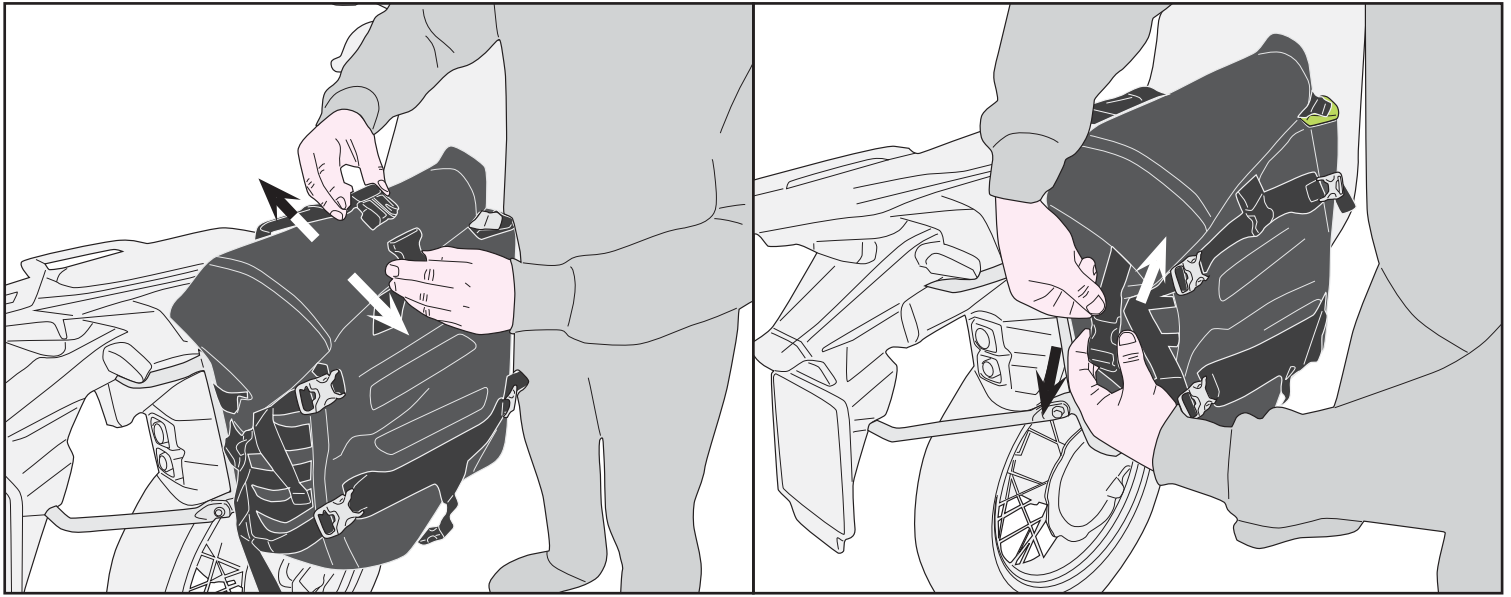

GRT709B

BORSE LATERALI 35+35LT - SIDE BAGS 35+35LTRS - SACOCHES LATÉRALES 35+35 LITRES SEITENTASCHEN MIT 35 + 35 LITER
ALFORJAS LATERALES 35+35 LITROS - SACOS LATERAIS 35 + 35 LITRO

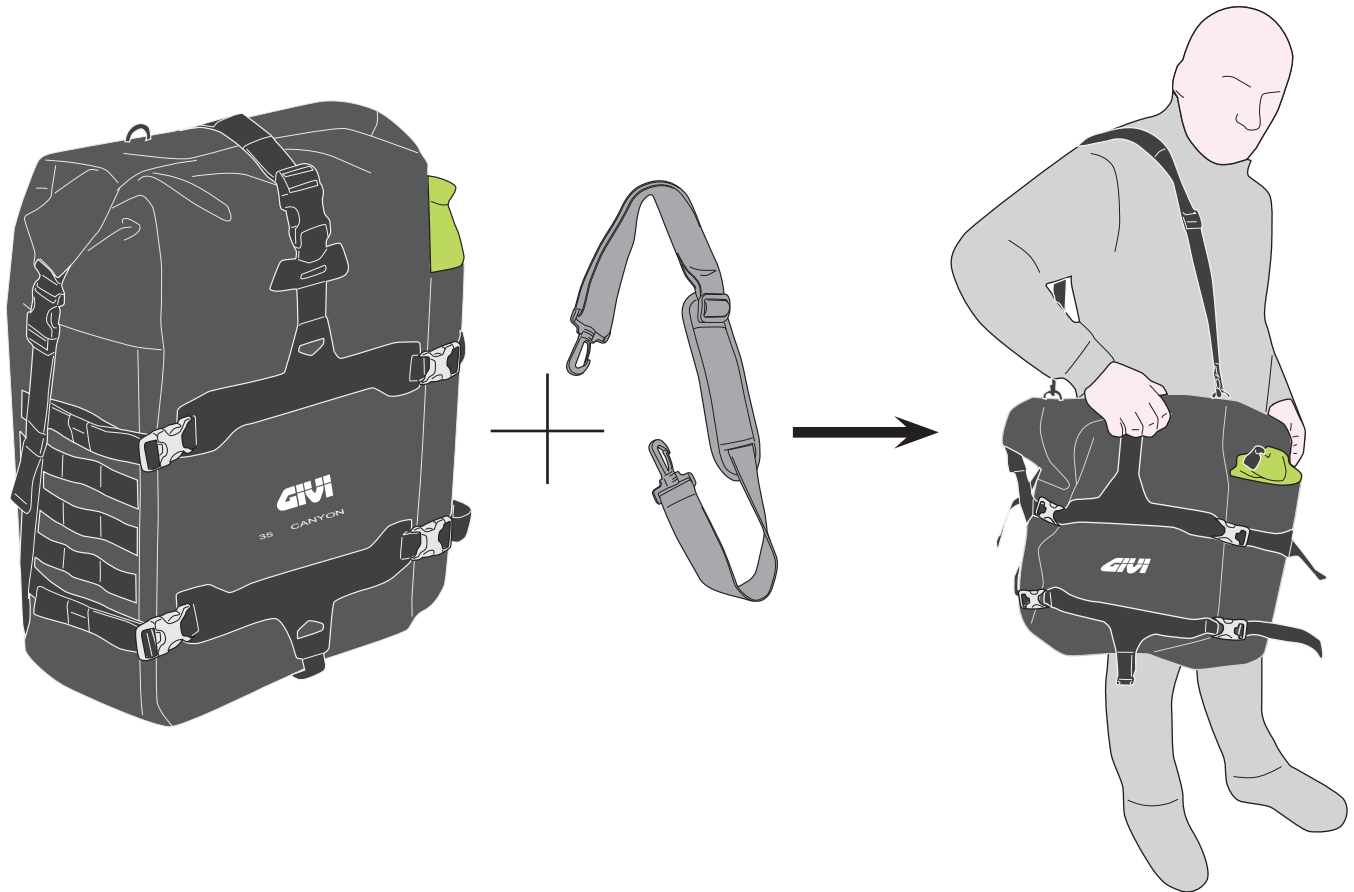
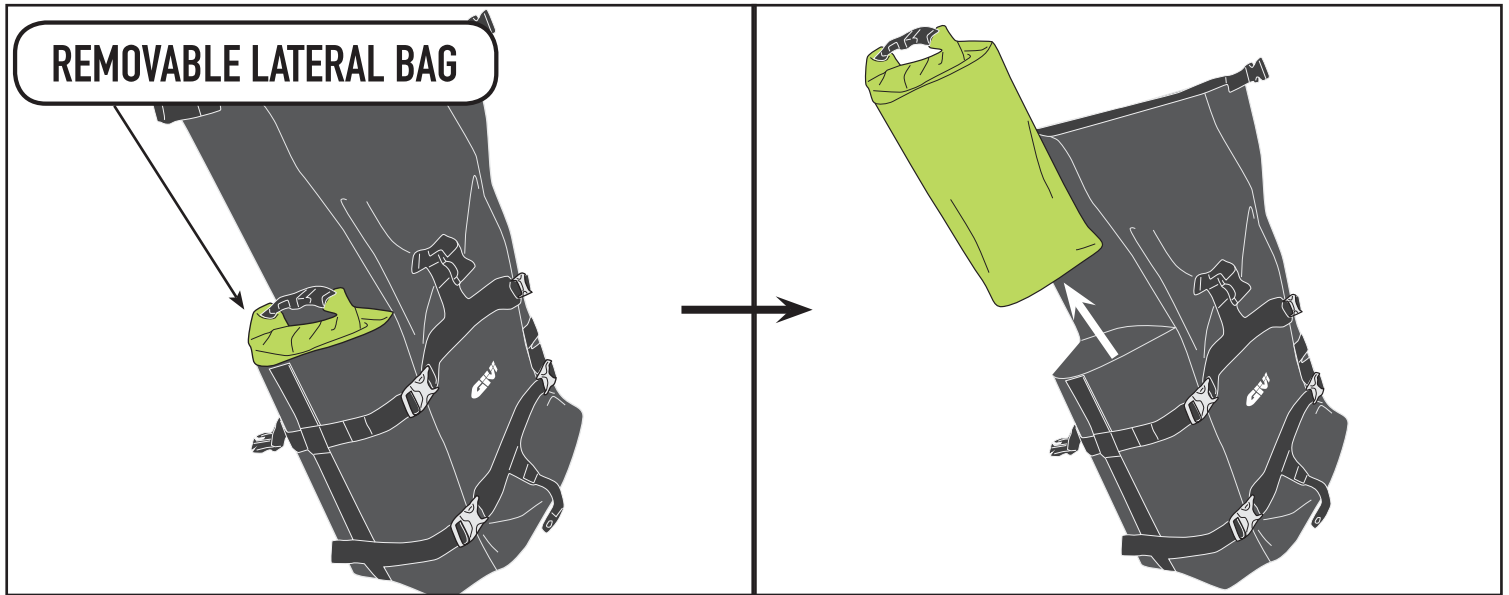

- ARROTOLARE PER 3 VOLTE SU SE STESSA L'APERTURA DELLA BORSA PER GARANTIRE L'IMPERMEABILITÀ
- TO ENSURE WATER RESISTANCE, IT IS ESSENTIAL TO ROLL DOWN THE OPENING OF THE BAG 3 TIMES
- ENROULER L'OUVERTURE DU SAC 3 FOIS SUR ELLE-MÊME AFIN D'ASSURER LA RÉSISTANCE À L'EAU
- UM ZU GARANTIEREN, DASS DIE TASCHE WASSERRESISTENT IST, IST ES NOTWENDIG DEN VERSCHLUSS 3X EINZUROLLEN.
- ENROLLAR 3 VECES SOBRE SÍ MISMA LA APERTURA DE LA BOLSA PARA GARANTIZAR LA IMPERMEABILIDAD.
- ENROLAR PARA 3 VEZES A ABERTURA DA BOLSA PARA GARANTIR A SUA IMPERMEABILIDADE.